

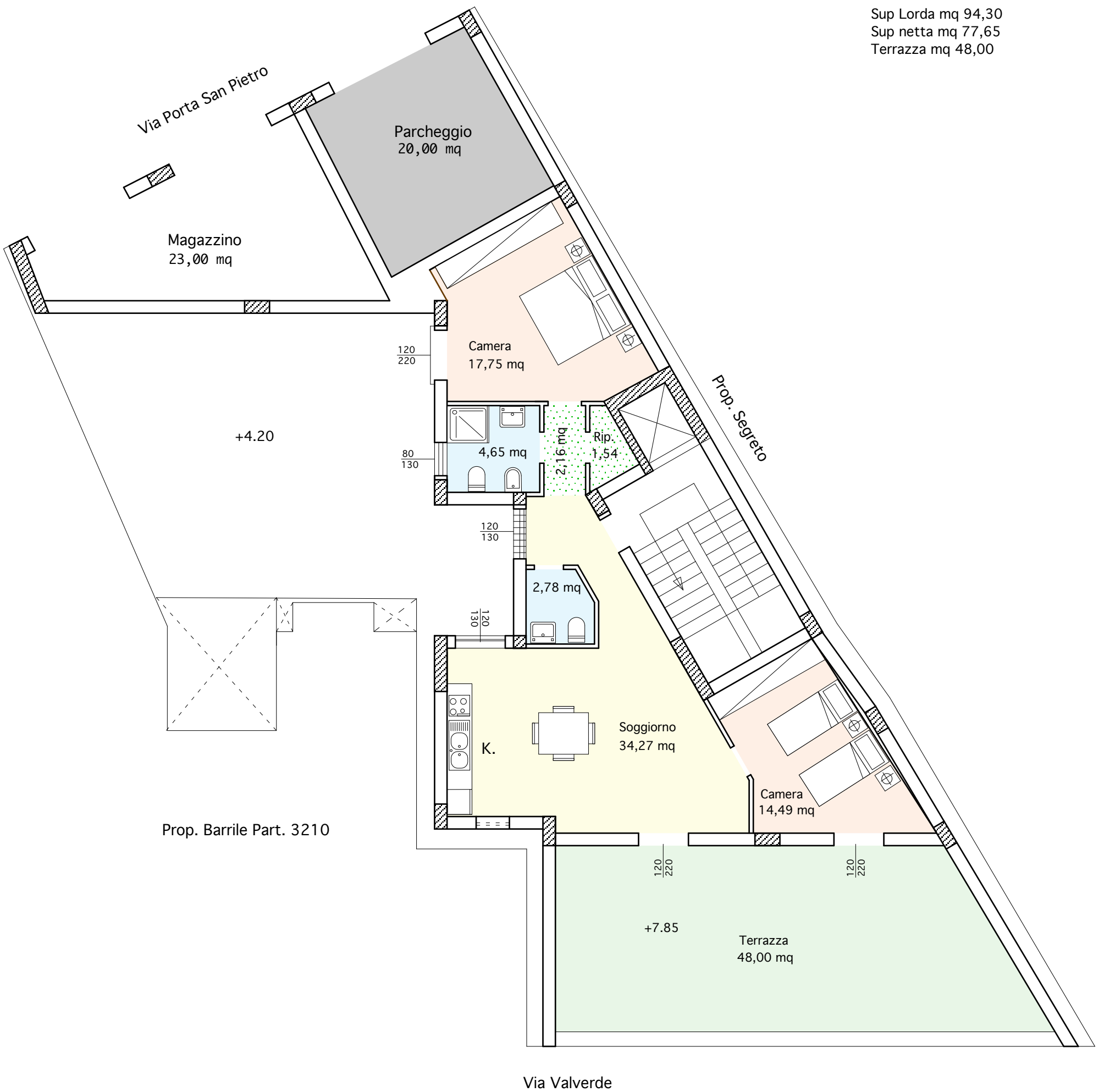

Sup Lorda 189,1 mq  
 Sup netta 150,92 mq  
 20,00 mq Balconi e verande  
 47,00 mq Area esterna di pertinenza

PIANTA PRIMO PIANO

Sup Lorda mq 94,30  
Sup netta mq 77,65  
Terrazza mq 48,00



Via Valverde

### PIANTA SECONDO PIANO

Sup Lorda mq 110  
Sup netta mq 92  
Terrazza mq 36



Via Valverde

### PIANTA TERZO PIANO

Sup Lorda mq 110  
Sup netta mq 92  
Balconi mq 10

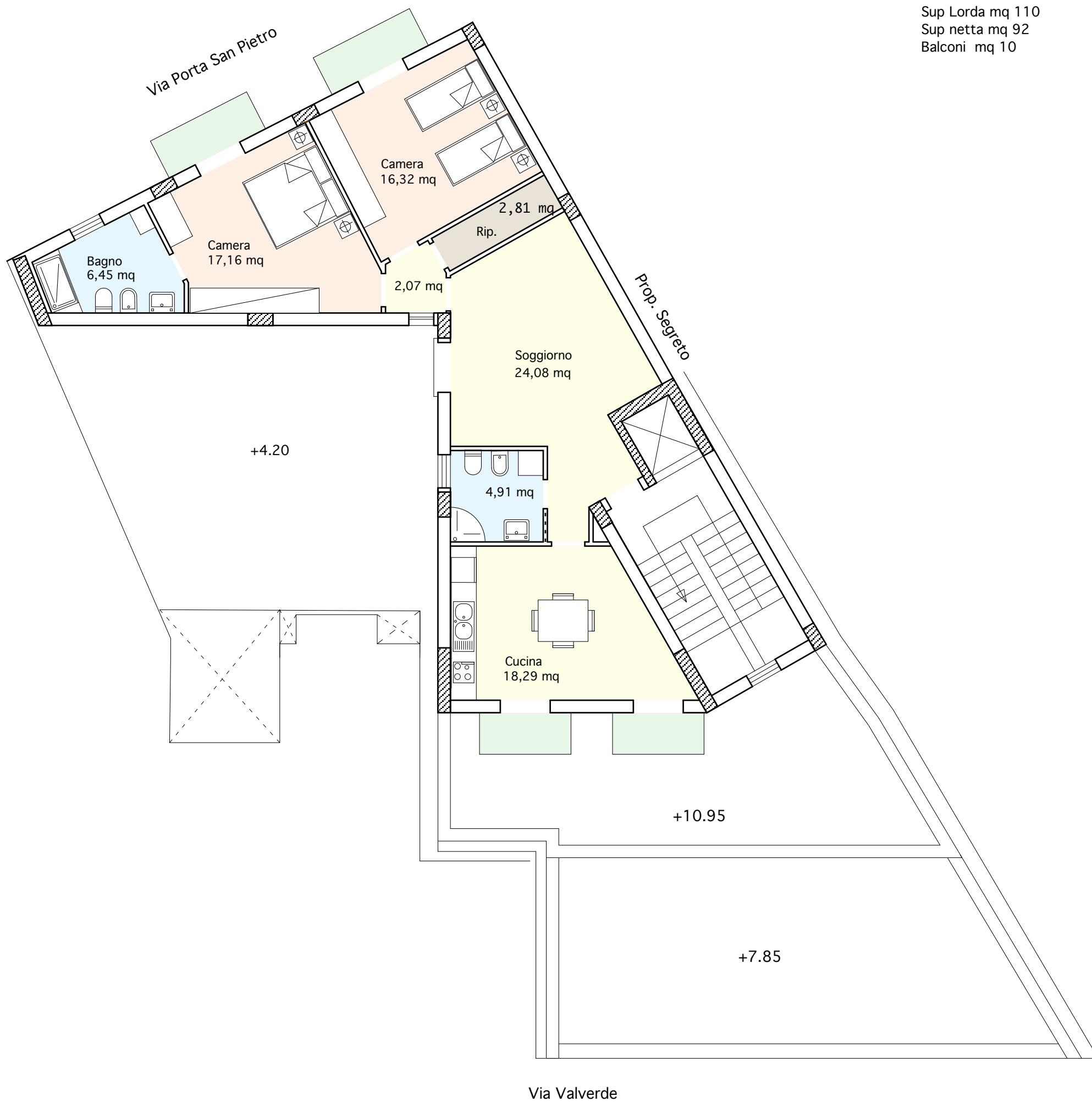

PIANTA QUARTO PIANO